



1x Fuse

2x Fuse hor. doubl



22

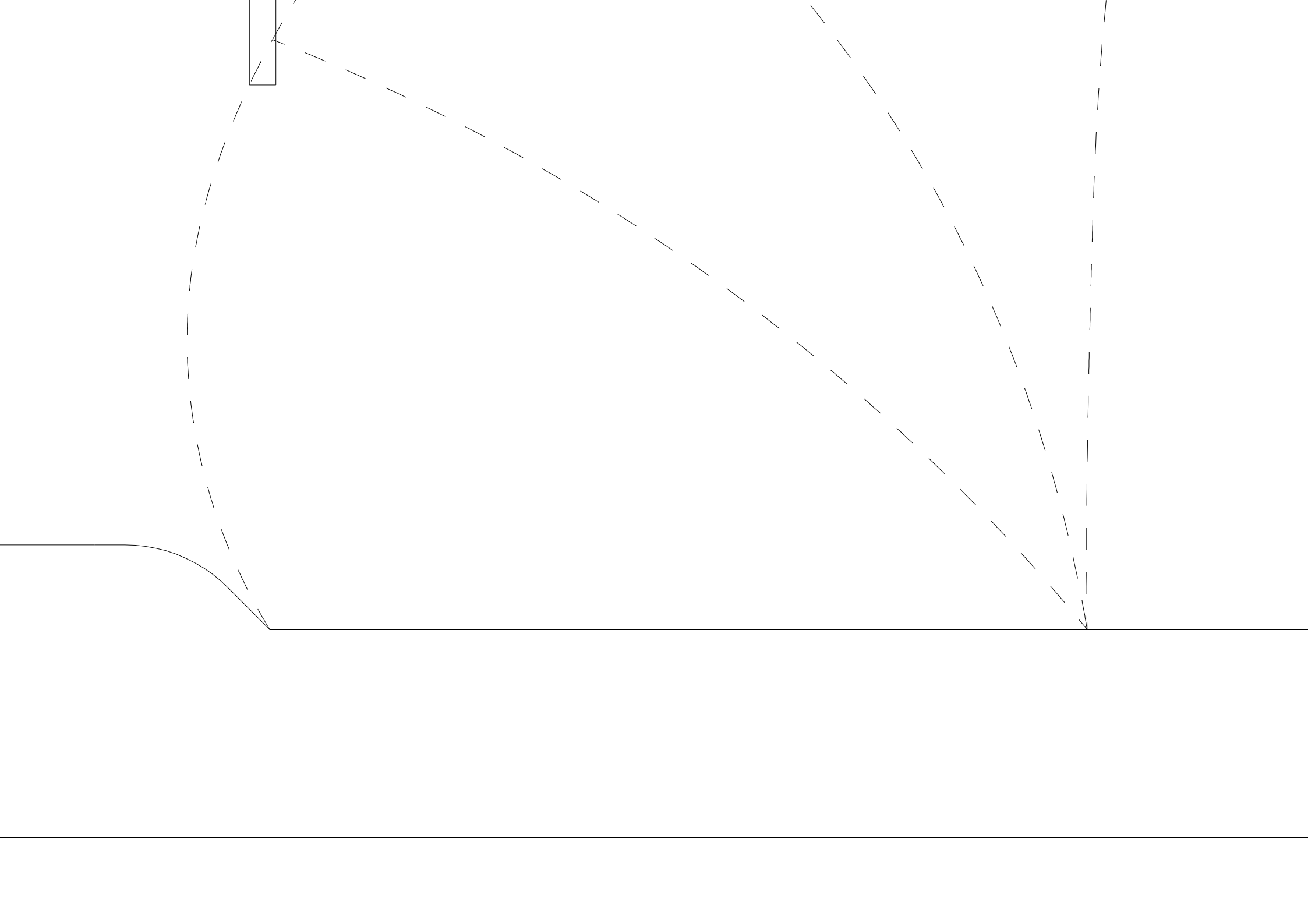

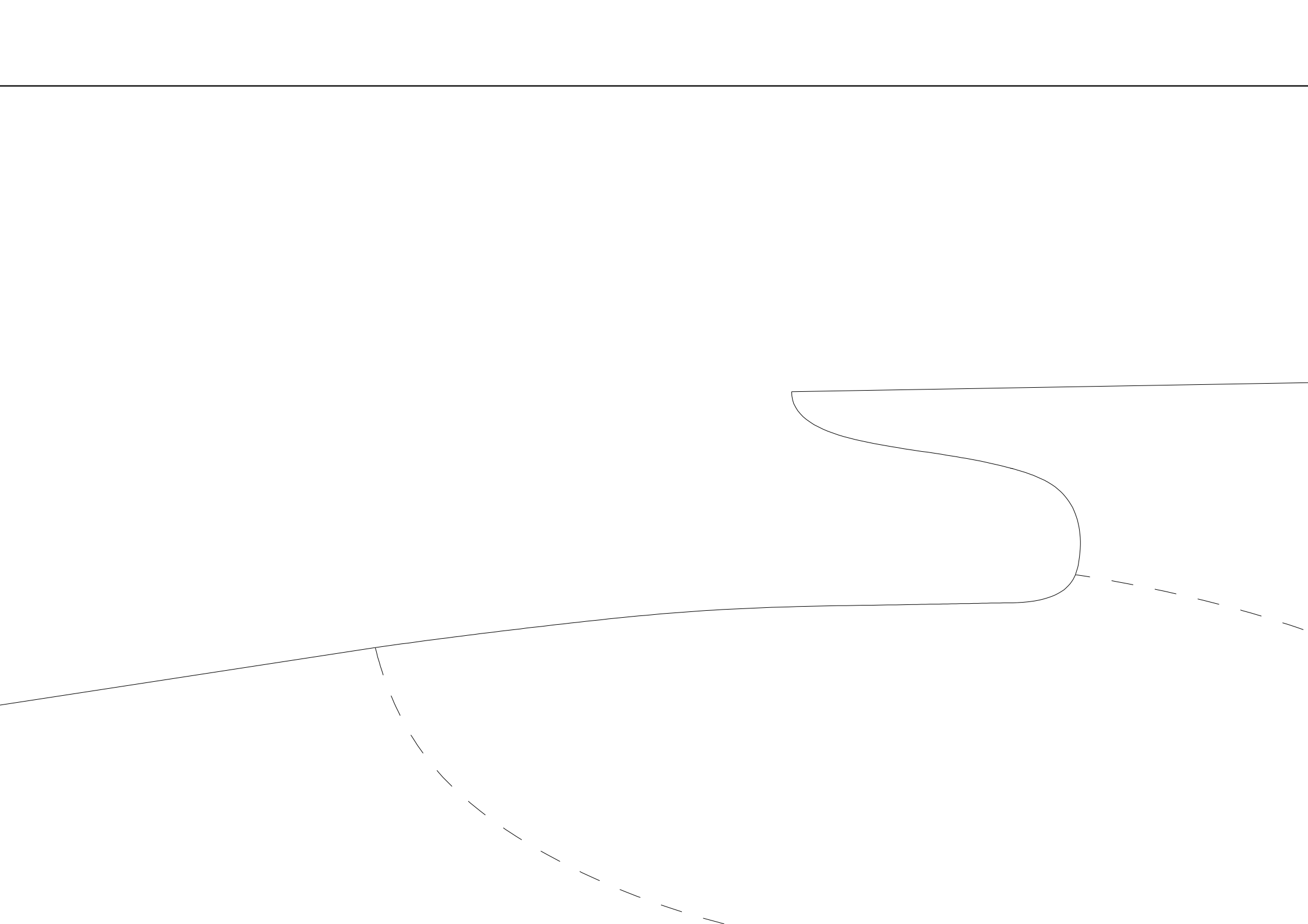

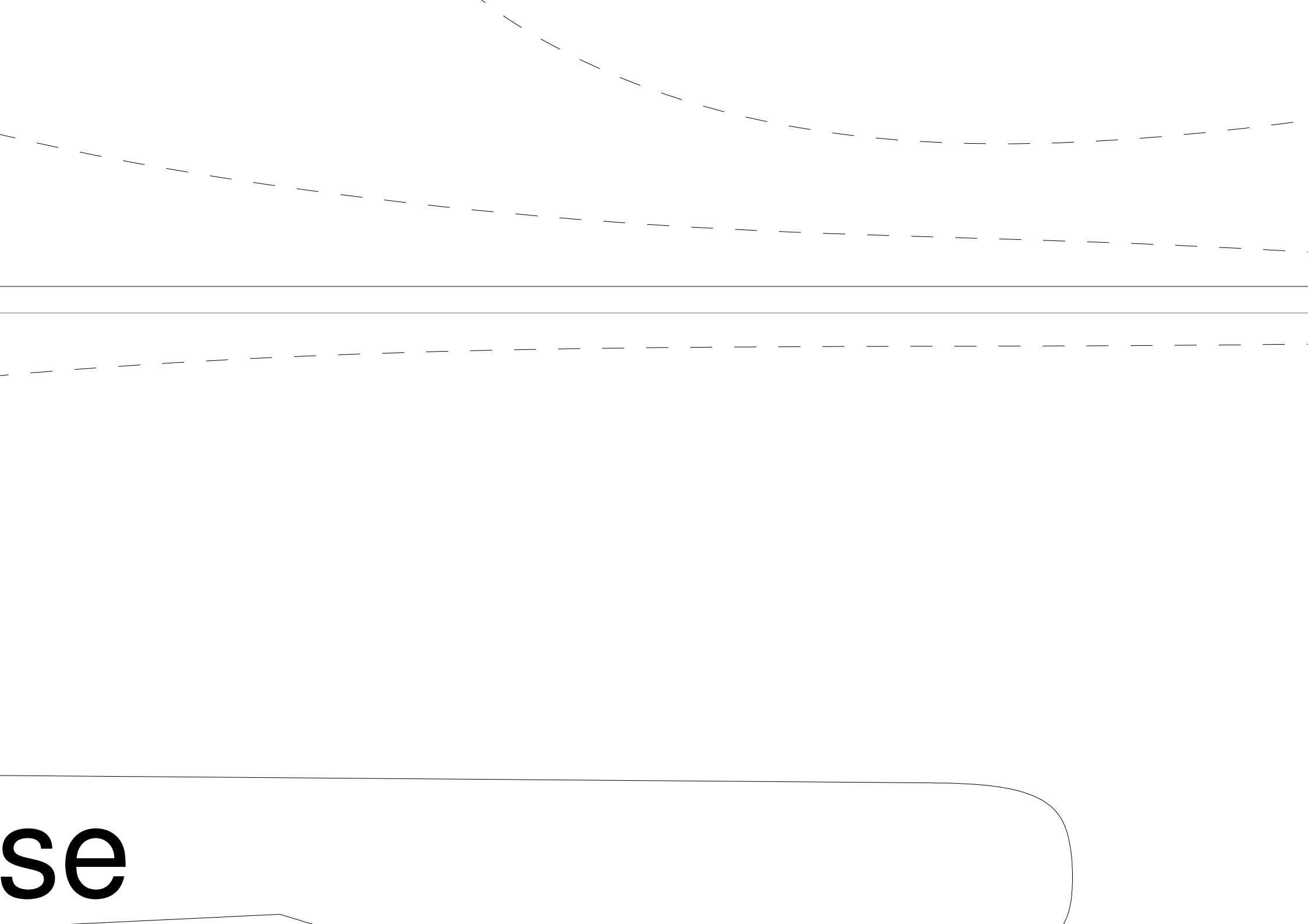

se

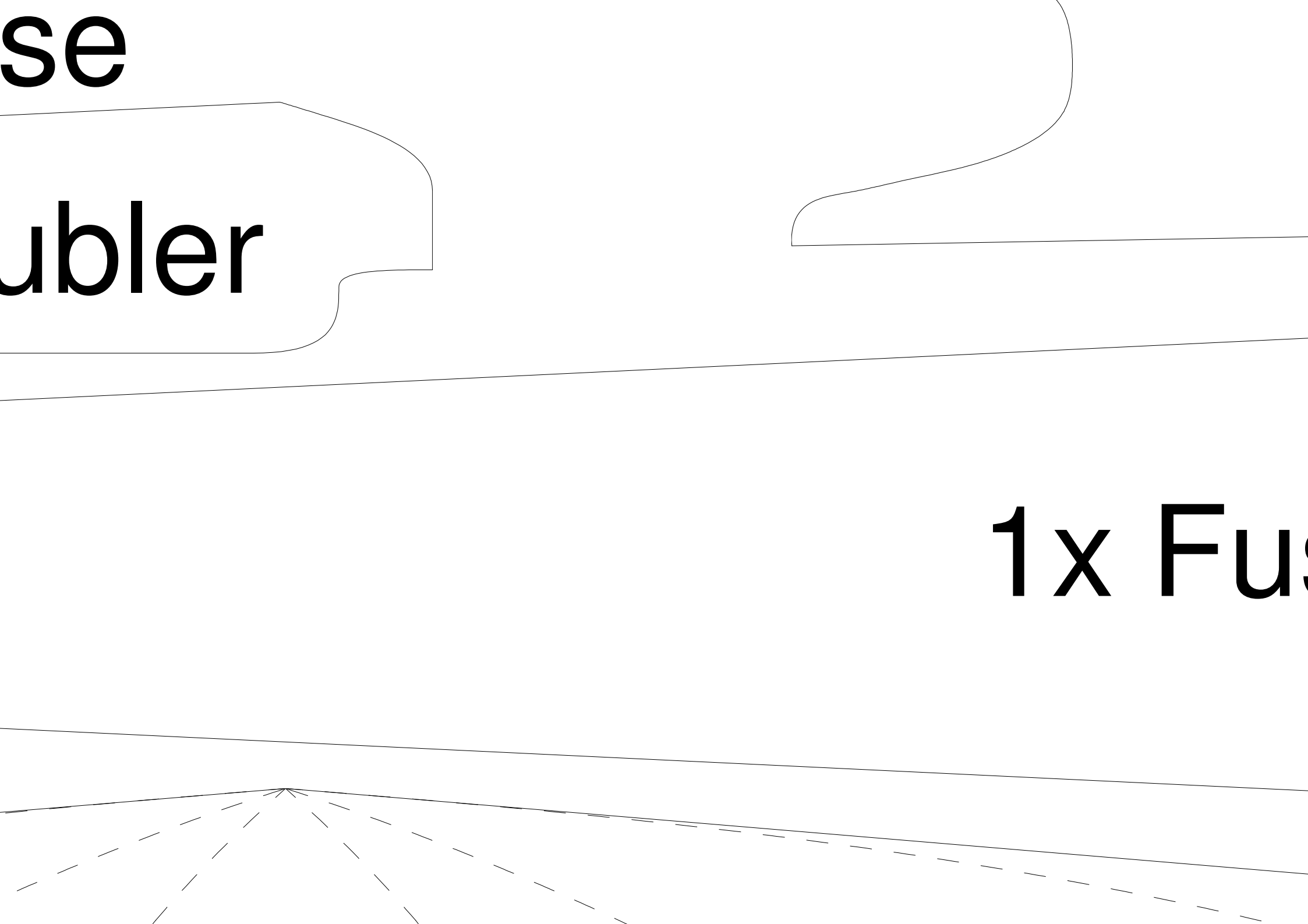

se

ubler

1x Fus



2x Wing

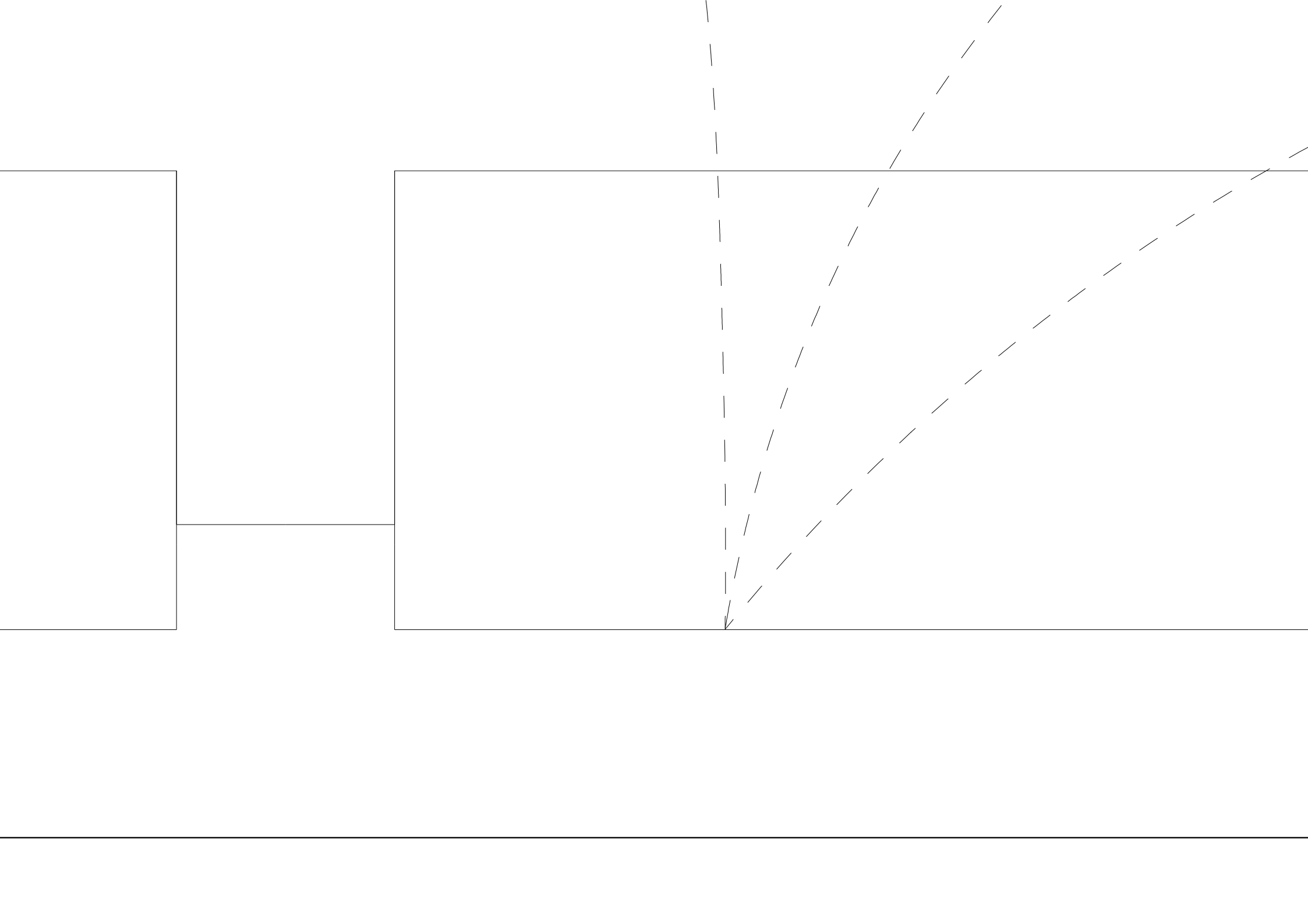

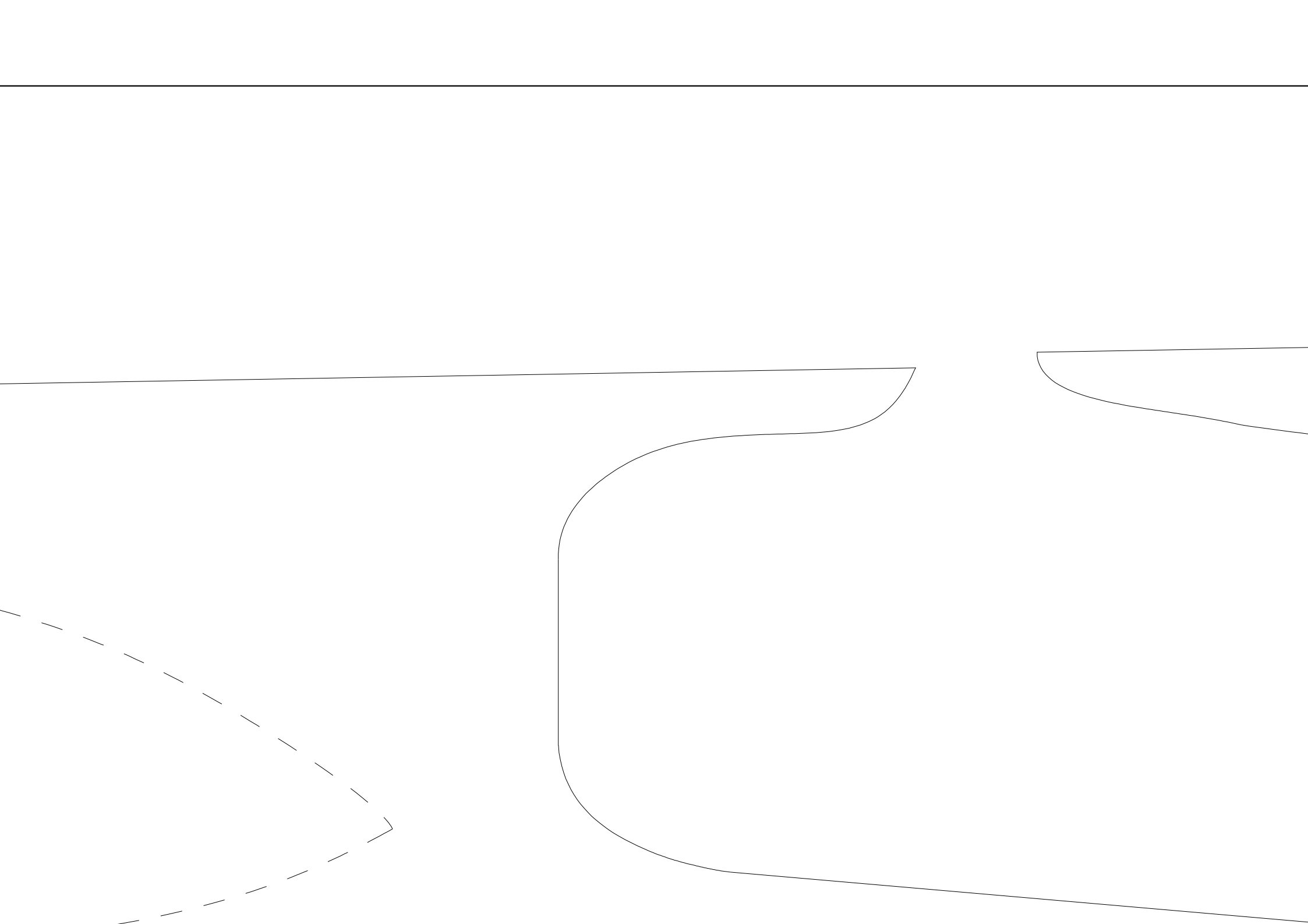

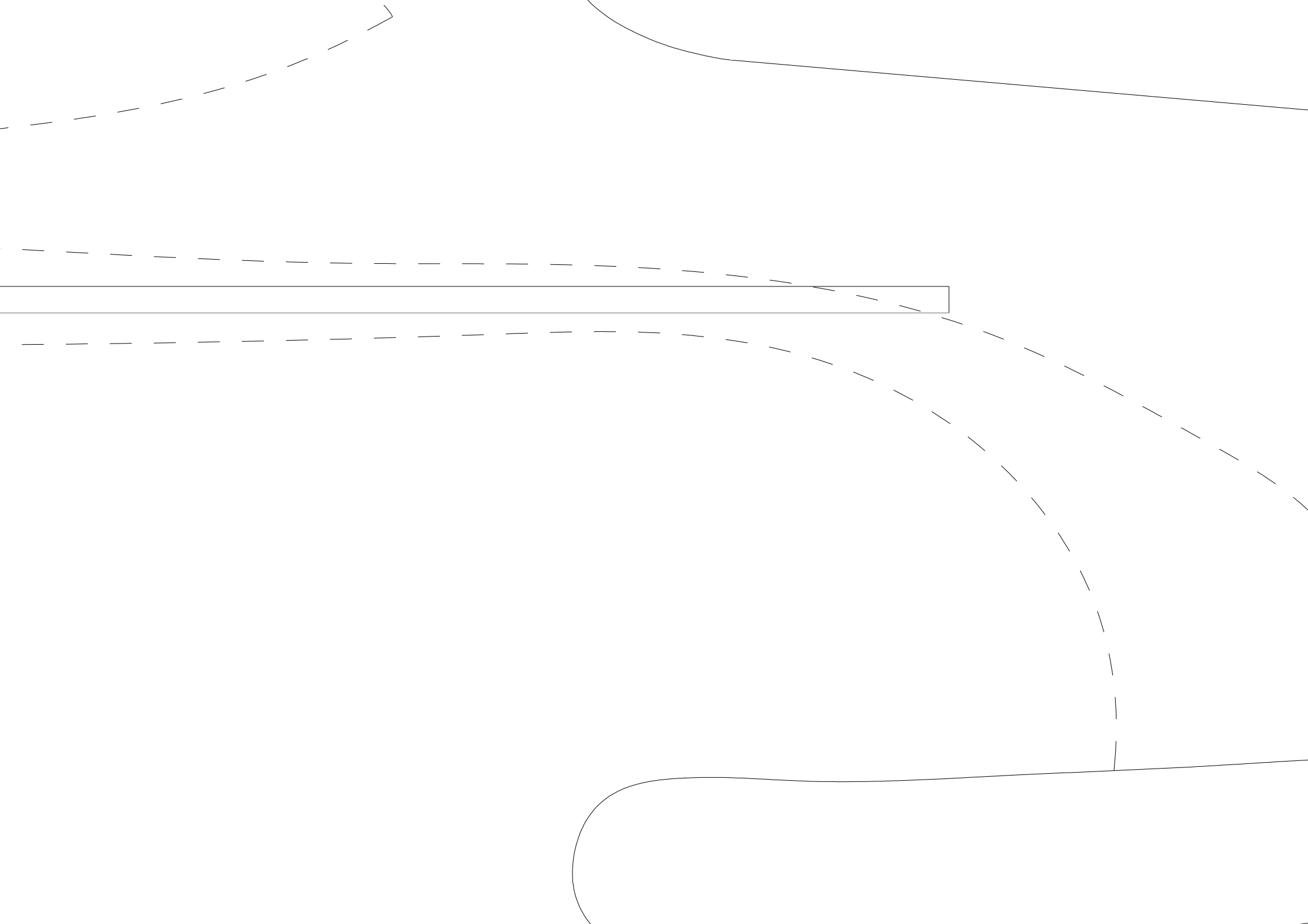

The background features several thin, black, hand-drawn style lines and shapes. At the top, there are two irregular, cloud-like shapes. Below them, a long, slightly wavy horizontal line spans across the upper middle section. To the right of this line, there is a small, rounded rectangular shape. Further down, a thin horizontal line is positioned above a rectangular box. At the bottom, two more thin, slightly curved lines are visible, one above the other.

use hor.



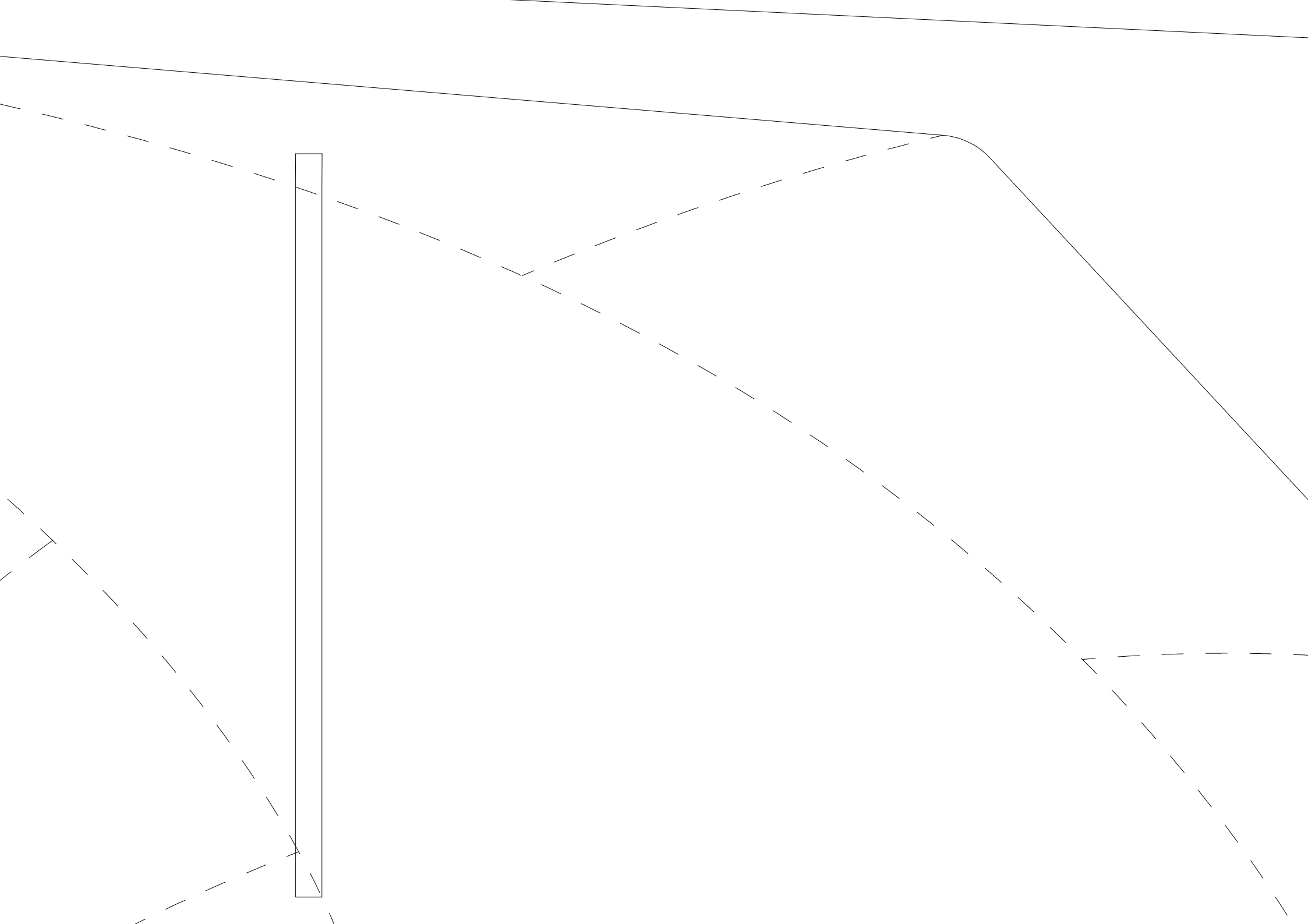

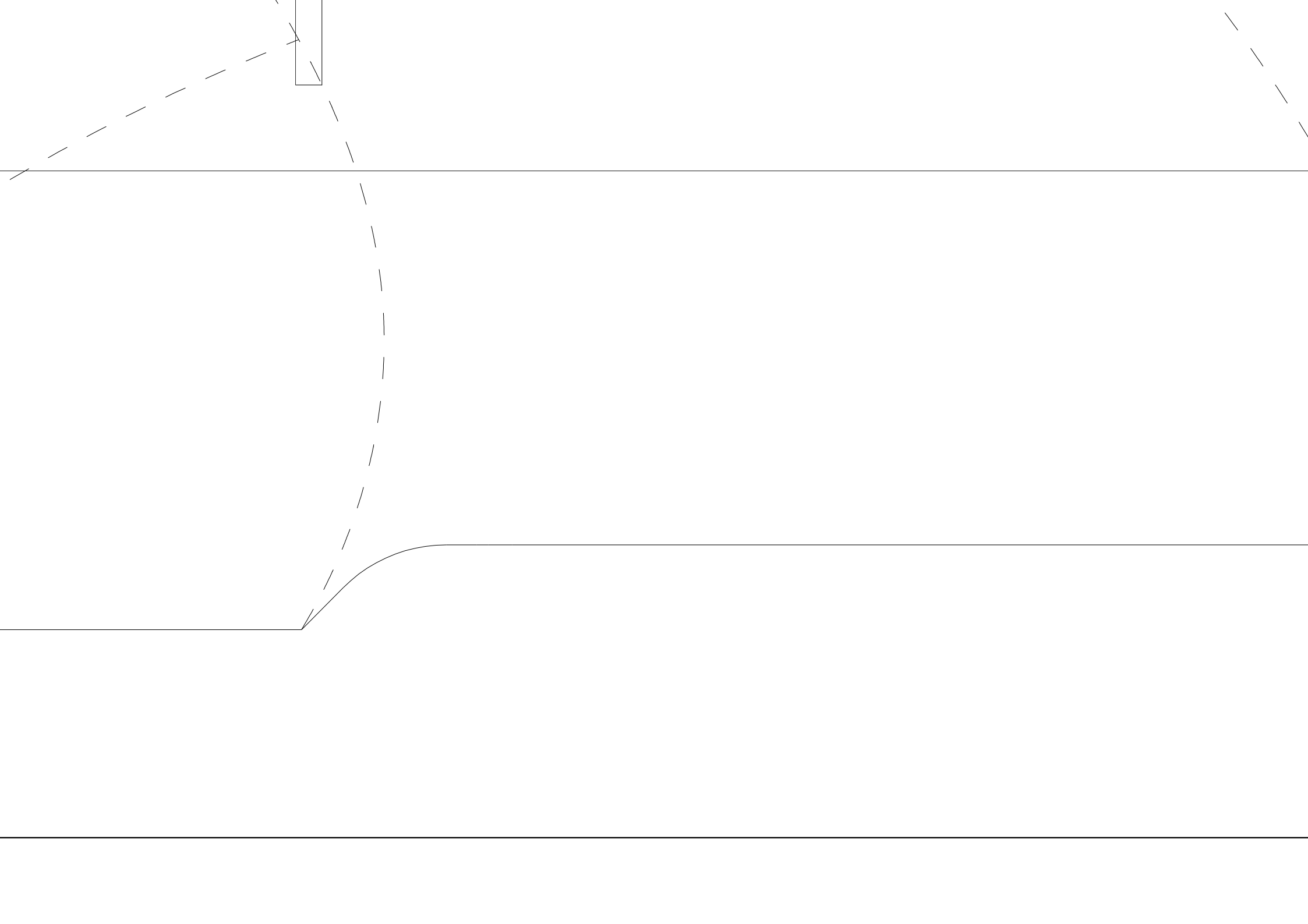





2x Fuse

2X Fuse

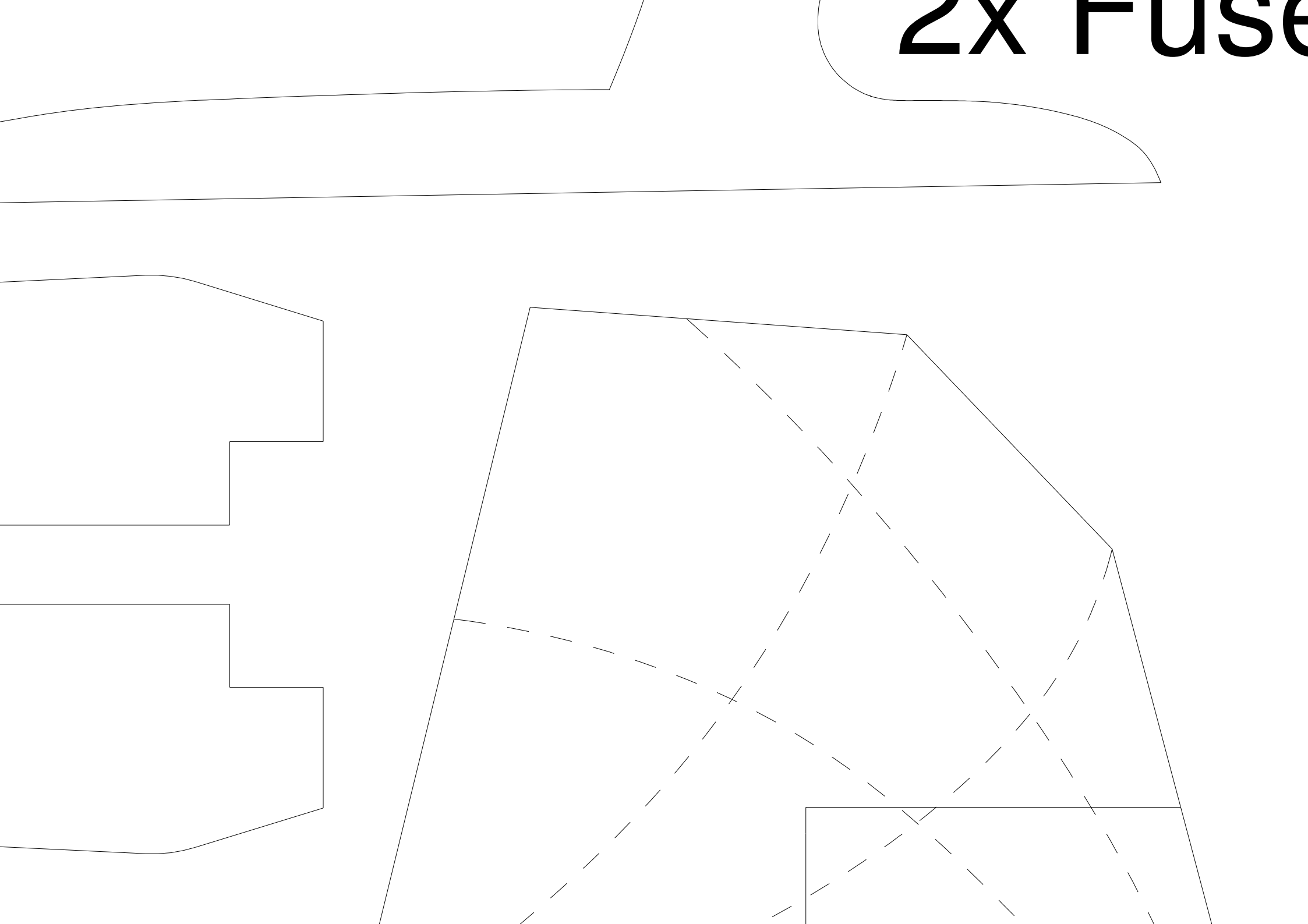



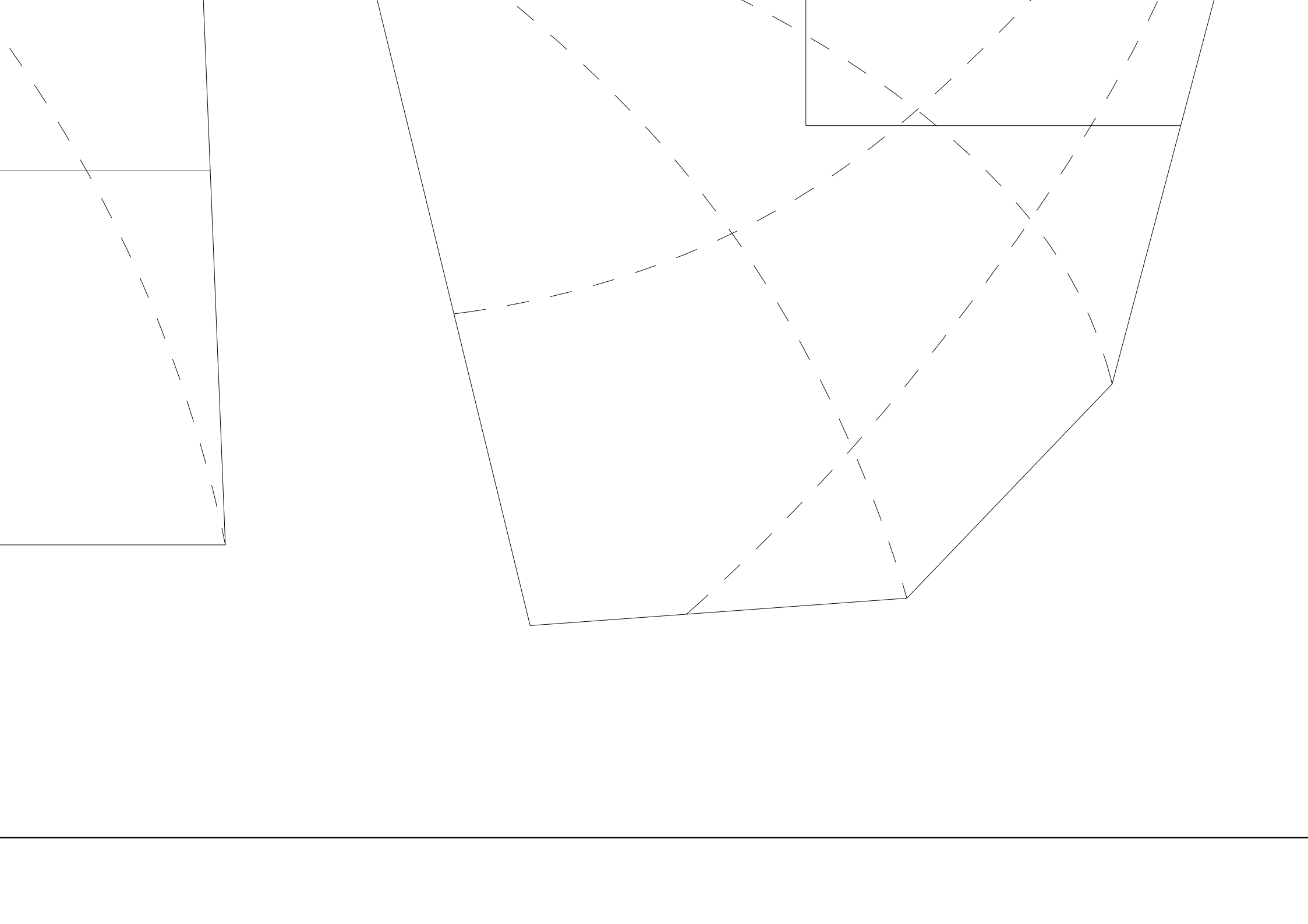

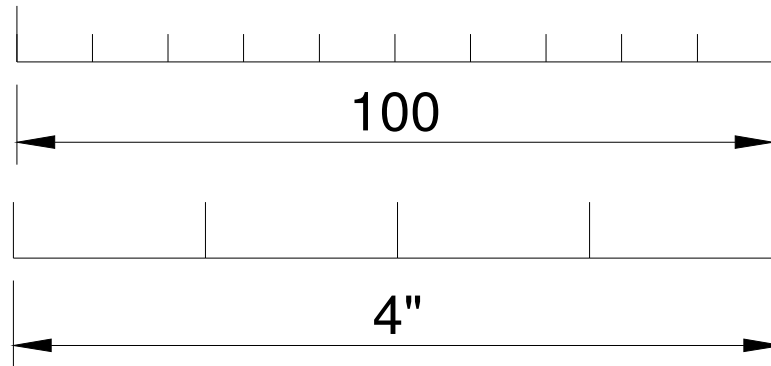

44" Monster Tensor

Based on the Micro-Tensor by Joe
Malinchak

DRAWN BY: PROP-ER

Wingspan: 44" (1100mm)

Material: FFF / 6mm Depron

This copyright protected plan is free for
personal,
non-commercial use only.

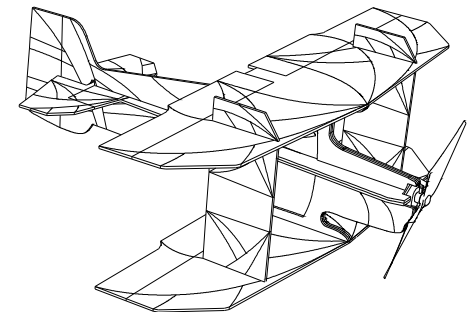
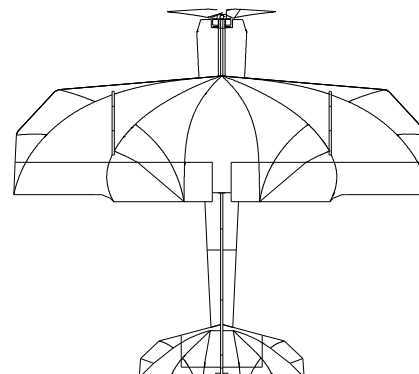

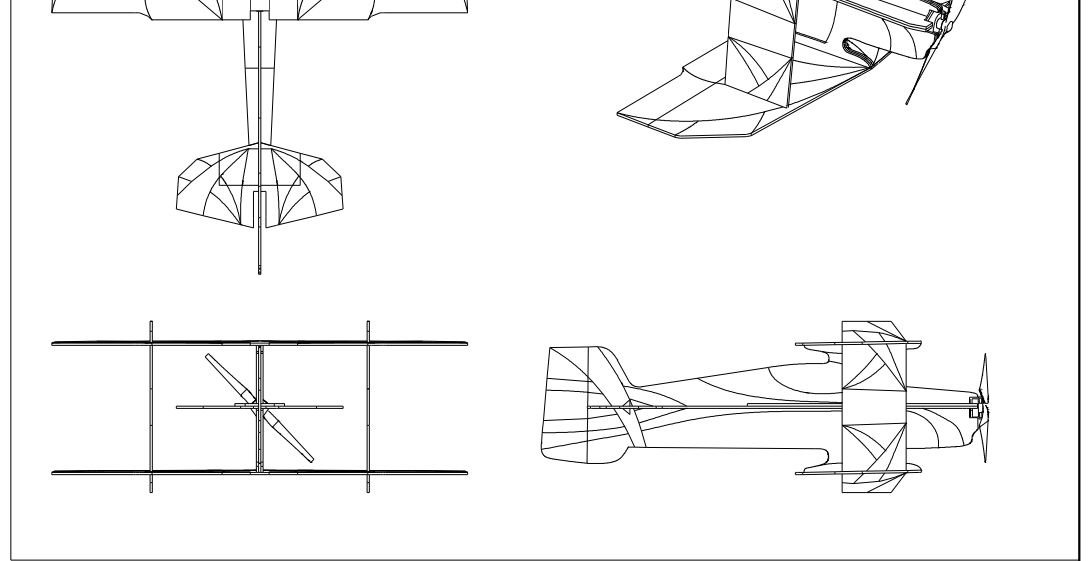
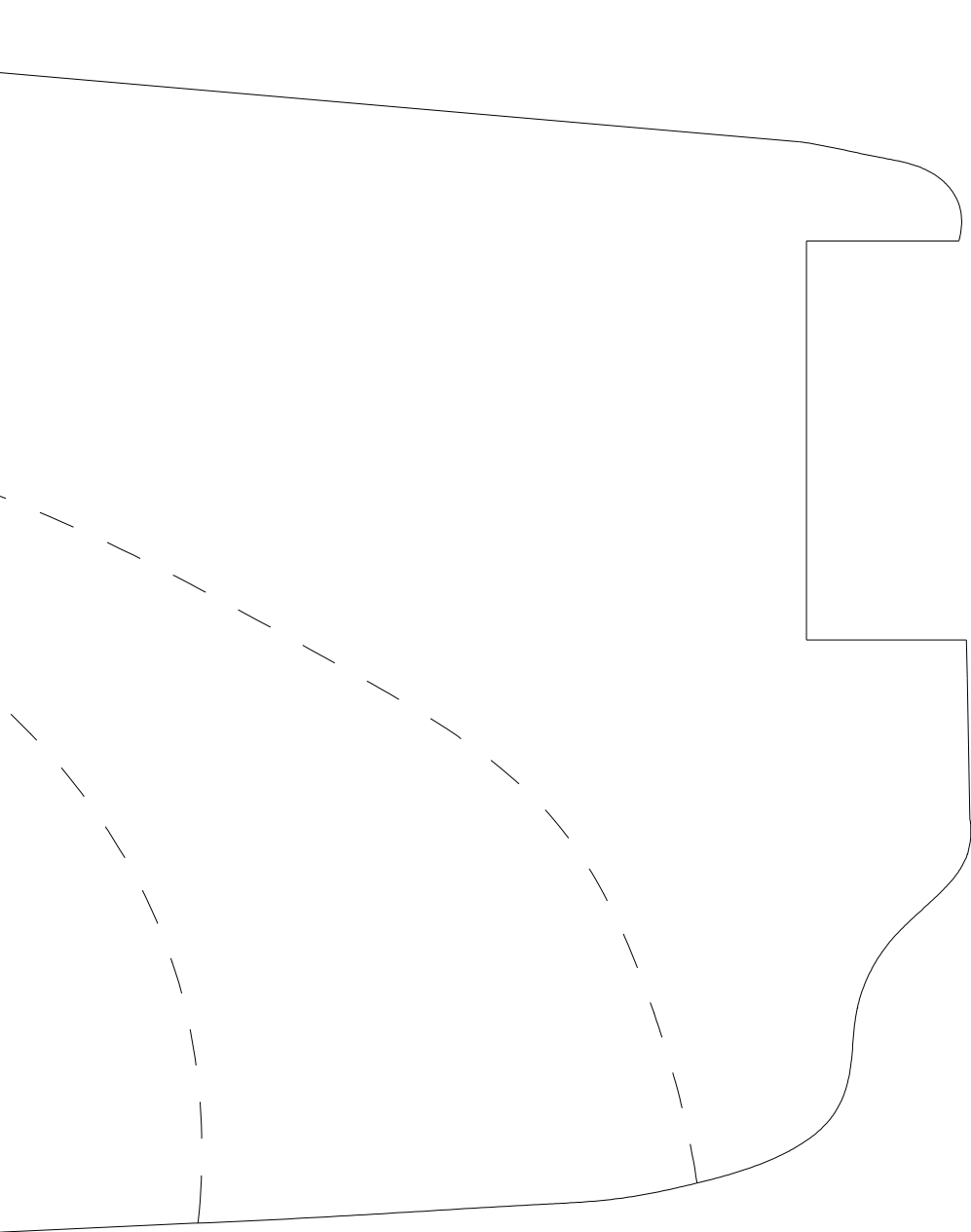

se doubler

se doubler

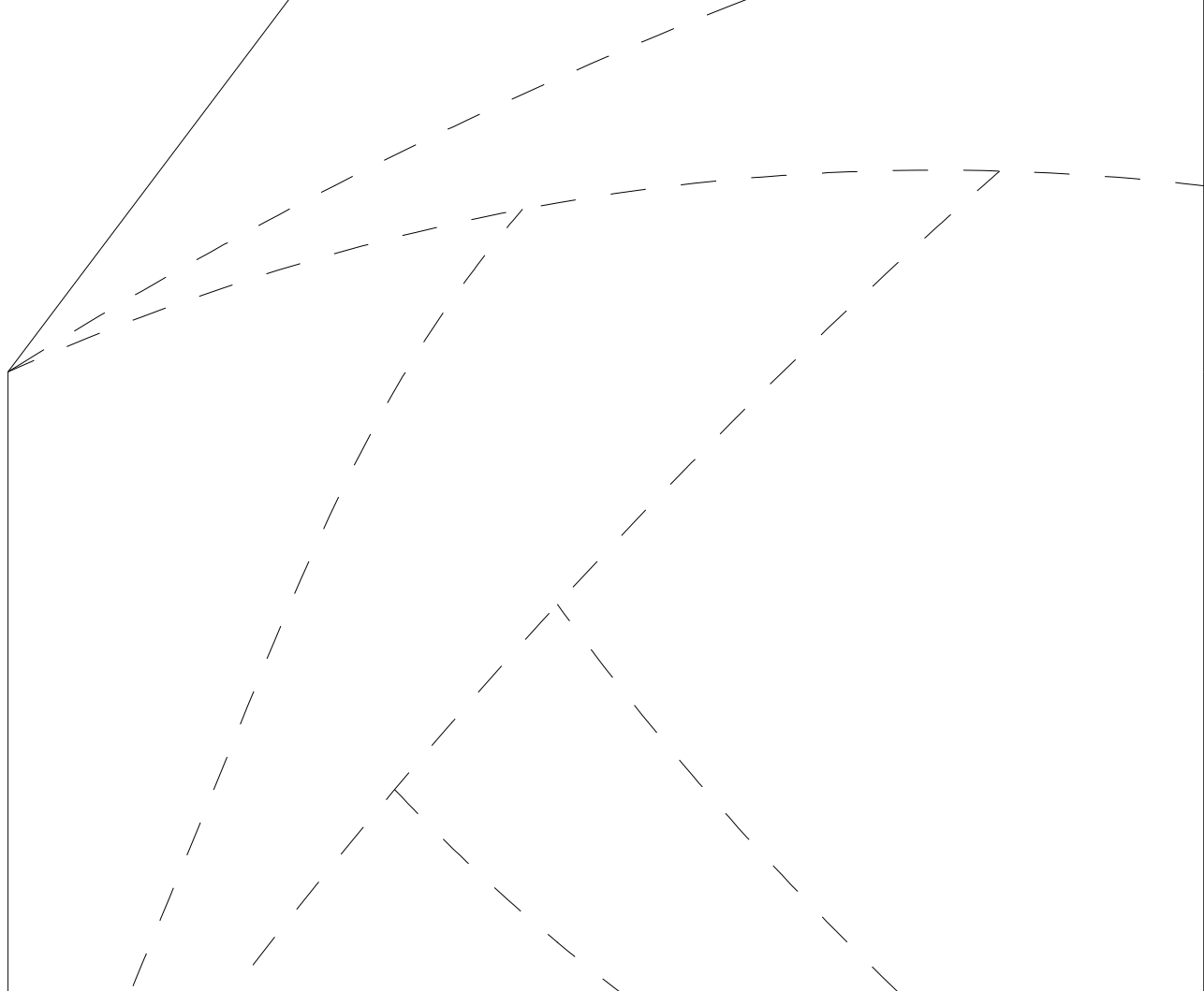

ators

1x Hor. stab.

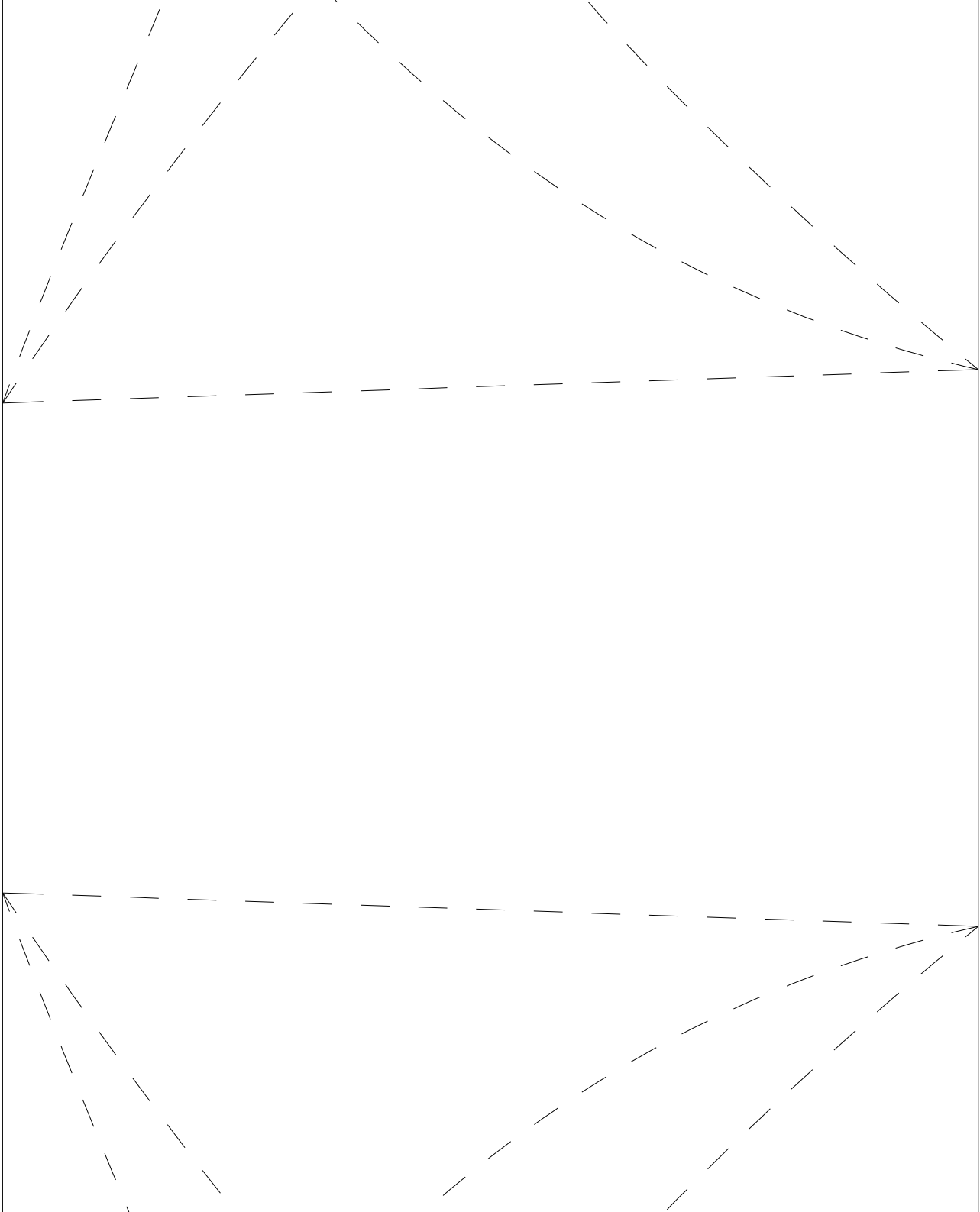

de force generat

2x Side

